

6

5

4

3

2

1

MATERIAL AND FINISH

Insulator: PBT, UL-94V-0 Rated, color (see ordering code)

Shell: Phosphor bronze, Tin plated

Contacts: Phosphor bronze, selective Gold over 50µin Nickel in contact area.

ELECTRICAL SPECIFICATIONS:

Rated current: 1 A, 30 VAC

Contact resistance: 30 mohm

Insulation resistance: 500 Mohm min. at 500 VDC

Dielectric withstanding voltage: 750 VAC for one minute

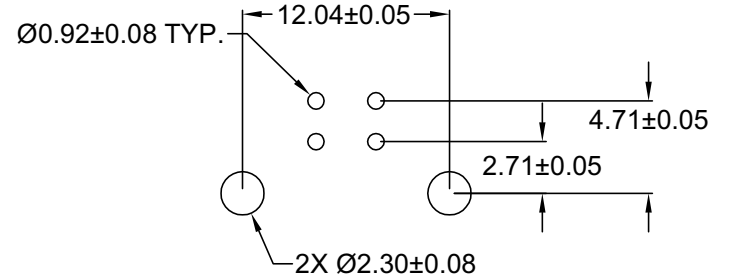
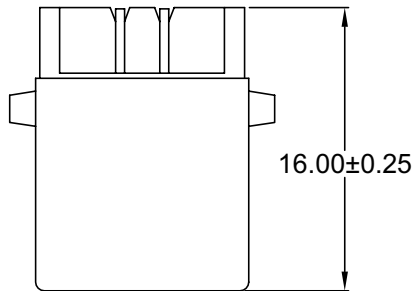

RECOMMENDED PCB LAYOUT (TOP VIEW)

ORDERING CODE:
USB-FA2RP 1
1

1) INSULATOR COLOR

- 1 = BEIGE
- 2 = BLACK
- 3 = WHITE

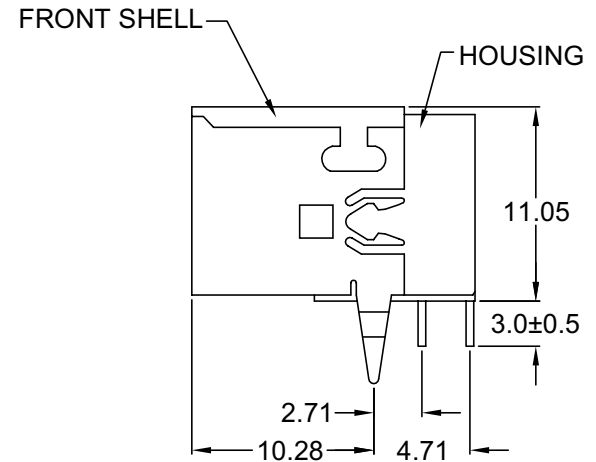
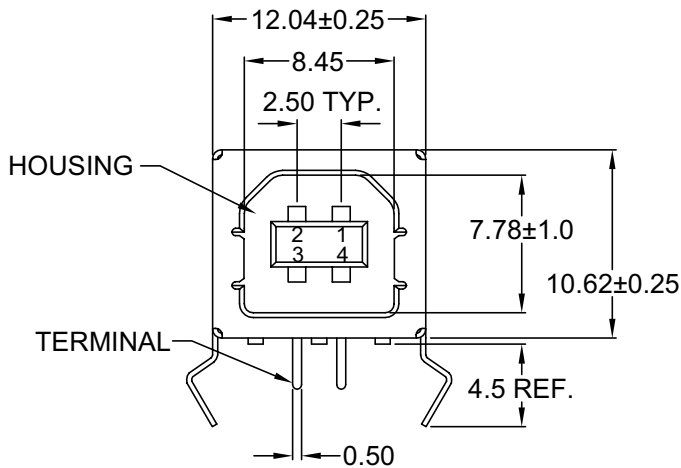

REVISIONS	CHNG	CHECK	APPR
	CHANGE		
REV	DATE		

TOLERANCE UNLESS OTHERWISE SPECIFIED		
X	±	1
X.X	±	0.4
X.XX	±	0.20
DRAWN BY	GQ	DATE: 06/24/02
CHECK BY	TD	DATE: 06/26/02
APPR BY	PB	DATE: 06/26/02

Power Dynamics, Inc.

Phone: 973 560-0019 Whippany, New Jersey Fax: 973 560-0076

PART: USB CONNECTOR, 'B' TYPE, FEMALE 90°
1 PORT, PCB MOUNT; WITHOUT REAR SHELL

PART #: USB-FB1RPX1		SHEET 1 of 1
SIZE: A	ALL DIMENSIONS FOR REFERENCE ONLY DIMENSIONS ARE IN MILLIMETERS	REV:
SCALE: NTS		

6

5

4

3

2

1

MATERIAL AND FINISH

Insulator (front & rear): PBT glass fiber, UL-94V-0 rated, color (see ordering code)

Shell (front & rear): SPCC, 100µ" min. Nickel plated

Contact: Brass, Gold (see chart) over Nickel plated on mating end, and Tin-Lead over Nickel plated on termination end

ELECTRICAL SPECIFICATIONS:

Insulation resistance: 100 Mohm min. @ 630 VDC

Dielectric withstanding voltage: 750 VAC for one minute

MECHANICAL:

Recommended wire gauge: 26 ~ 28 AWG

ENVIRONMENTAL:

Temperature rating: -55°C to +85°C

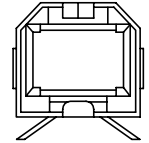
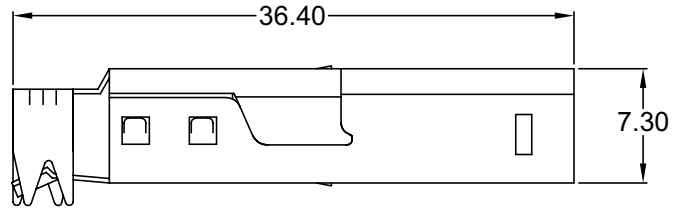
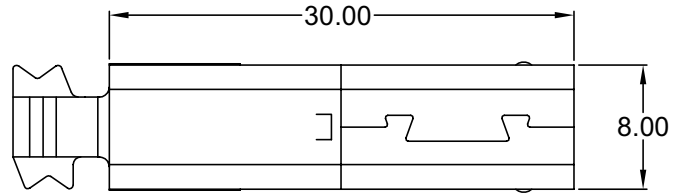

ORDERING CODE:

USB-MB1SS
 1 2

1) INSULATOR COLOR

- 1 = BEIGE
- 2 = BLACK
- 3 = WHITE

2) PLATING

SEE CHART

NOTE: SEE SHEET 2 FOR ASSEMBLY

CONTACT

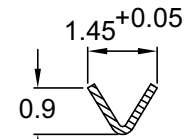
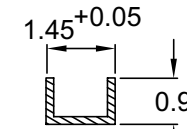
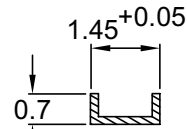
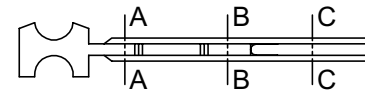
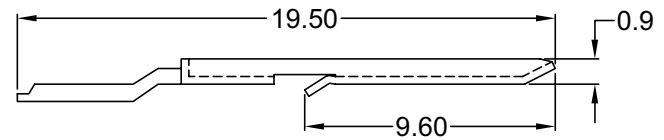

SECTION A-A

SECTION B-B

SECTION C-C

TOLERANCE
UNLESS OTHERWISE SPECIFIED

- X ± 1
- X.X ± 0.4
- X.XX ± 0.20

Power Dynamics, Inc.

Phone: 973 560-0019 Whippany, New Jersey Fax: 973 560-0076

PART: USB B TYPE
INSULATOR AND CONTACTS

P/N	PLATING
USB-MB1SSX1	GOLD FLASH
USB-MB1SSX2	10µ"
USB-MB1SSX3	15µ"
USB-MB1SSX4	30µ"

DRAWN BY	GQ	DATE:	06/26/02
CHECK BY	TD	DATE:	06/27/02
APPR BY	PB	DATE:	06/27/02

PART #: USB-MB1SSXX		SHEET 1 of 2
SIZE: A	ALL DIMENSIONS FOR REFERENCE ONLY	
SCALE: NTS	DIMENSIONS ARE IN MILLIMETERS	
REV:		

REV	DATE	CHANGE	CHKG	CHKD	APPR

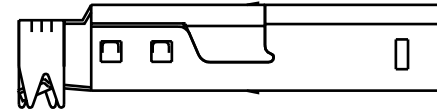
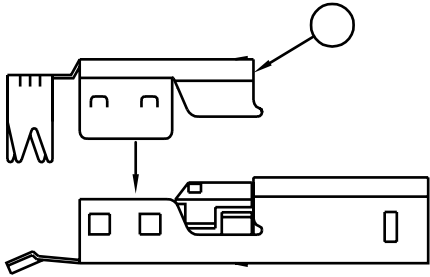
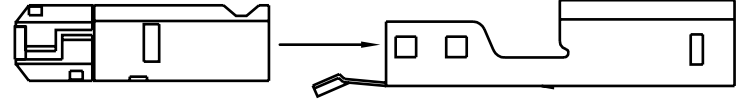
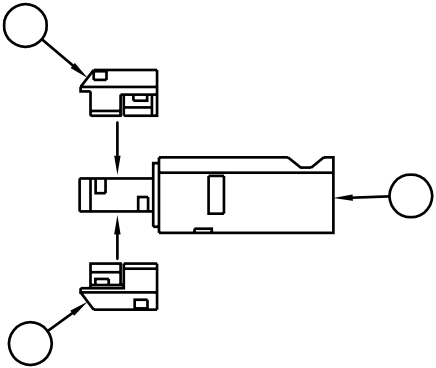

Dynamics, Inc.

