

6

5

4

3

2

1

MATERIAL AND FINISH

Insulator: Polycarbonate, UL-94V-0 rated
Contacts: Brass, Tin Plated

ELECTRICAL SPECIFICATIONS:



Current rating: 10 A/15 A
Voltage rating: 250 VAC
Insulation resistance: 100 Mohm min. at 500 VDC
Dielectric withstanding voltage: 2000 VAC for one minute





ORDERING CODE:

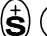

43R09-1 $\frac{4}{1 \ 2}$

- 1) COLOR
1 = BLACK
2 = GRAY

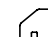
2) ELECTRICAL CIRCUIT CONFIGURATION

2 = 10A 250V 70°C   

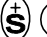
15A 250V 70°C    
2+GROUND

3 = 10A 250V 70°C   

15A 250V 70°C    
2+GROUND

with additional solder terminal on ground

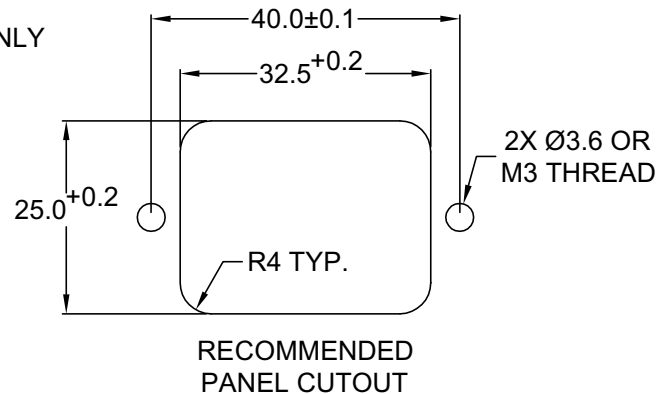
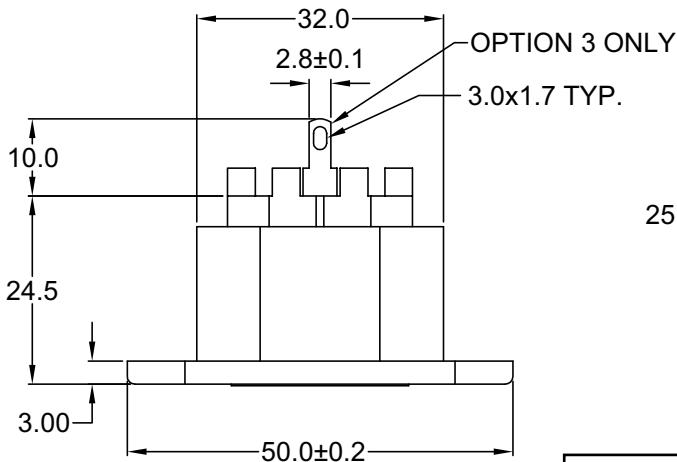

Distributed by Electro-Stock, Inc. sales@electrostock.com
630-682-1542 Fax 630-682-1562 http://www.electrostock.com

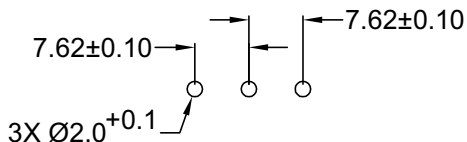
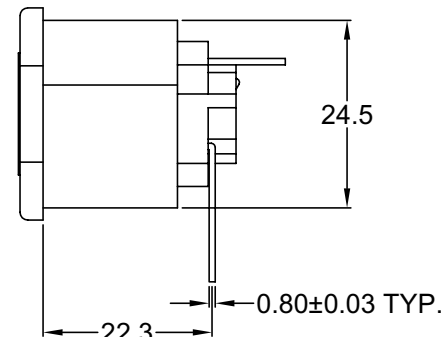
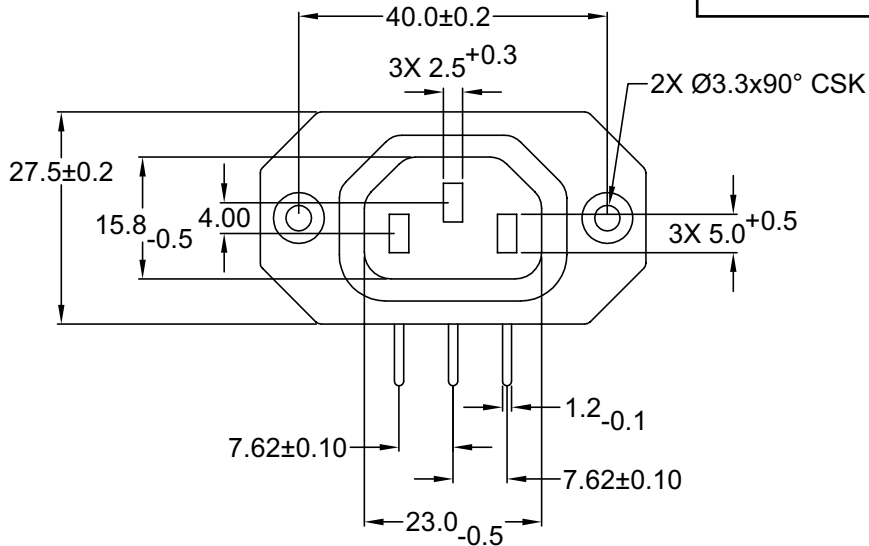

RECOMMENDED PCB LAYOUT

REV	DATE	CHNG	CHECK	APPR
		CHANGE		

TOLERANCE UNLESS OTHERWISE SPECIFIED			
X	± 1		
X.X	± 0.4		
X.XX	± 0.20		
DRAWN BY	GQ	DATE:	10/10/01
CHECK BY	TD	DATE:	10/11/01
APPR BY	PB	DATE:	10/11/01

Power Dynamics, Inc.	
Phone: 973 560-0019 Whippany, New Jersey Fax: 973 560-0076	
PART: 10A/15A IEC 60320 APPL. OUTLET; R/A DOWN-WARD PC TERMINALS; SIDE FLANGE, PANEL MOUNT	
PART #: 43R09-1X4X	
SIZE: A	ALL DIMENSIONS FOR REFERENCE ONLY DIMENSIONS ARE IN MILLIMETERS
SCALE: NTS	
SHEET 1 of 1	
REV:	

6

5

4

3

2

1