



MINI-DIN CONNECTOR, DUAL PORT

CENTURY INTERCONNECT PRODUCTS

Distributed by Electro-Stock, Inc. sales@electrostock.com
630-682-1542 Fax 630-682-1562 http://www.electrostock.com

ORDERING INFORMATION

CMDS XX - B - A - XX

1 2 3 4 5

1...Series CMDS Fully shielded dual port mini DIN connector

2...Number of Contacts

08...08 contacts

12...12 contacts

3...Grounding Bracket Style

B...With retention grounding brackets

4...Grounding Tab Style

A...With straight grounding tab

5...Dual Shield Style*

01...Dual shield (12 contact version only)

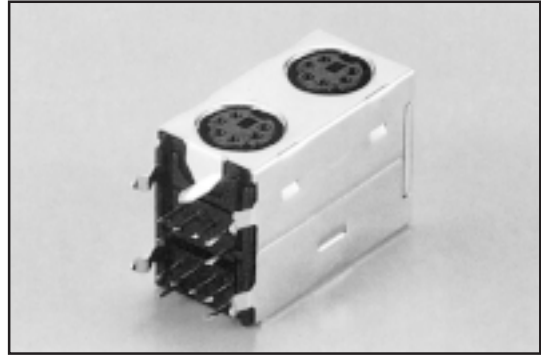

SPECIFICATIONS

Insulator Material: Thermoplastic PBT, black color

Flammability Rating: UL94V-0

Contact Material: Phosphor Bronze

Contact Plating: 50 μ " nickel over 120 μ " tin lead on solder tail, selective gold flash on contact area

Shield Material: 120 μ " bright tin over 50 μ " minimum nickel

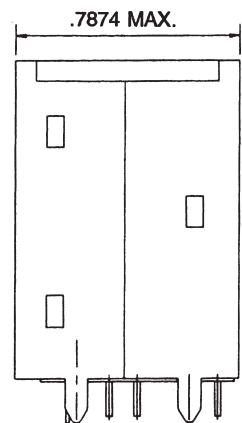
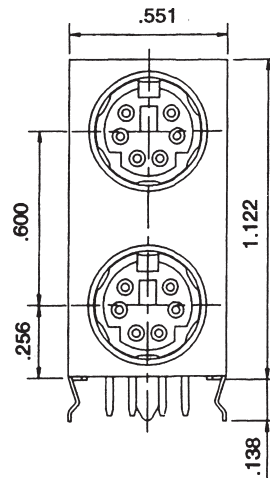

FULL SHIELD

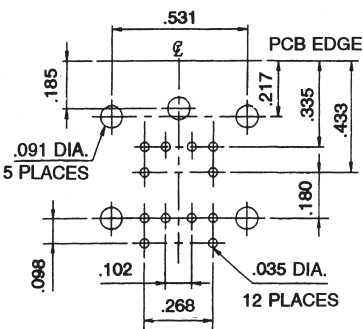

PCB LAYOUT

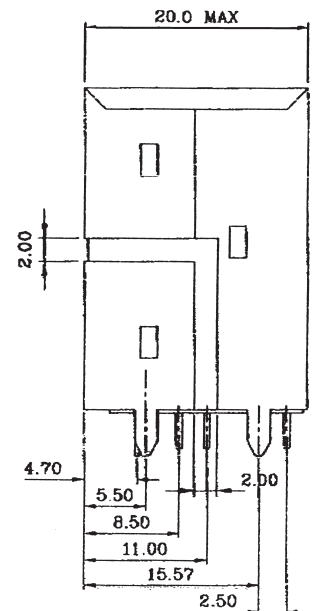
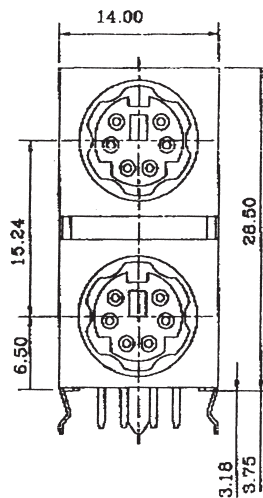
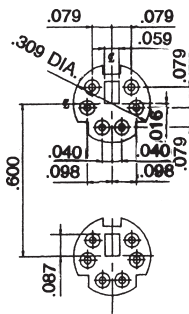

DUAL SHIELD

* Dual shield for isolated grounding applications.