

# SERIES 213 LED SOCKET, HORIZONTAL 90° (SOLID FRAME)

# 214 ZIG-ZAG SOCKET (SOLID FRAME)

## SERIES 213

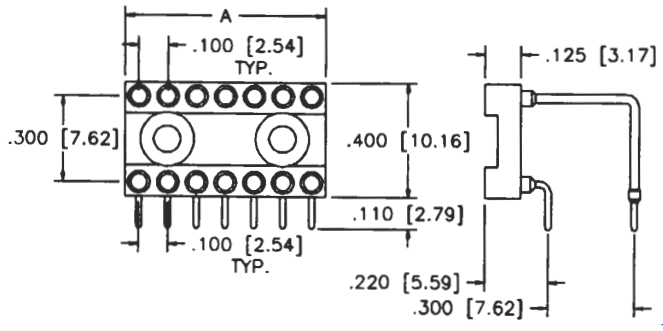

PIN	DIM "A"	ORDER-CODE
6	.295 [7.49]	306-90S-
8	.395 [10.03]	308-90S-
10	.495 [12.57]	310-90S-
14	.695 [17.65]	314-90S-
16	.795 [20.19]	316-90S-
18	.895 [22.73]	318-90S-
20	.995 [25.27]	320-90S-

Distributed by: Electro-Stock, Inc. sales@electrostock.com  
<http://www.electrostock.com> 630-682-1542 Fax: 630-682-1562

## SERIES 214

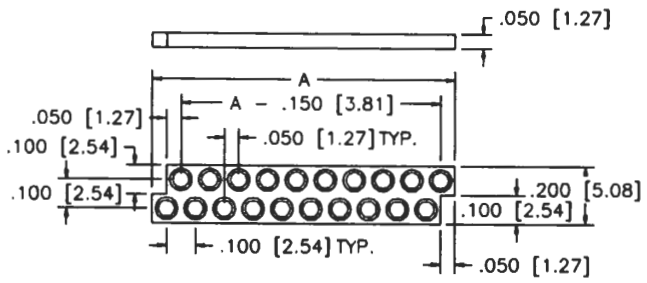

PIN	DIM "A"	ORDER-CODE
20	1.050 [26.67]	220-
24	1.250 [31.75]	224
40	2.050 [52.07]	240-
64	3.250 [82.55]	264-

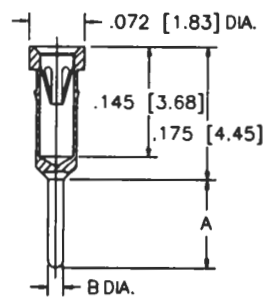
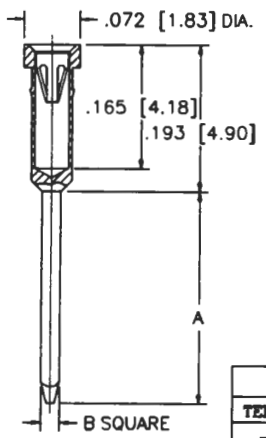
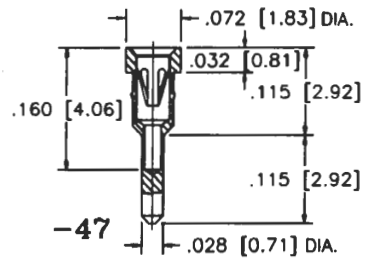

FIG. D



TERMINAL CHART			
TERMINAL	FIG.	DIM "A"	DIM "B"
-01	D	.115 [2.92]	.020 [0.51]
-03	C	.510 [12.95]	.025 [0.64]
-08	D	.170 [4.31]	.020 [0.51]
-94	D	.125 [3.17]	.018 [0.46]

FIG. C

### CONTACT TYPE

S: STANDARD DIP	INSERTION FORCE	9.0 oz. AVG.
	WITHDRAWAL FORCE	2.0 oz. MIN.
M: STANDARD PGA	INSERTION FORCE	1.6 oz. MAX.
	WITHDRAWAL FORCE	0.5 oz. MIN.
L: INTERSTITIAL PGA	INSERTION FORCE	1.0 oz. MAX.
	WITHDRAWAL FORCE	0.3 oz. MIN.
H: HIGH FORCE	INSERTION FORCE	18.3 oz. MAX.
	WITHDRAWAL FORCE	4.2 oz. MIN.

### TECHNICAL SPECIFICATIONS

**MATERIAL**  
 INSULATOR: GLASS FILLED POLYESTER  
 UL 94V-0 LISTED

**TERMINAL CONTACT**  
 BRASS PER ASTM-B16  
 BeCu PER ASTM-B194

**OPERATING TEMP.** -65°C TO +125°C

**CONTACT FORCES**  
 INSERTION STANDARD 9 oz. AVG.  
 WITHDRAWAL STANDARD 2 oz. MIN.

### ORDERING INFORMATION

